

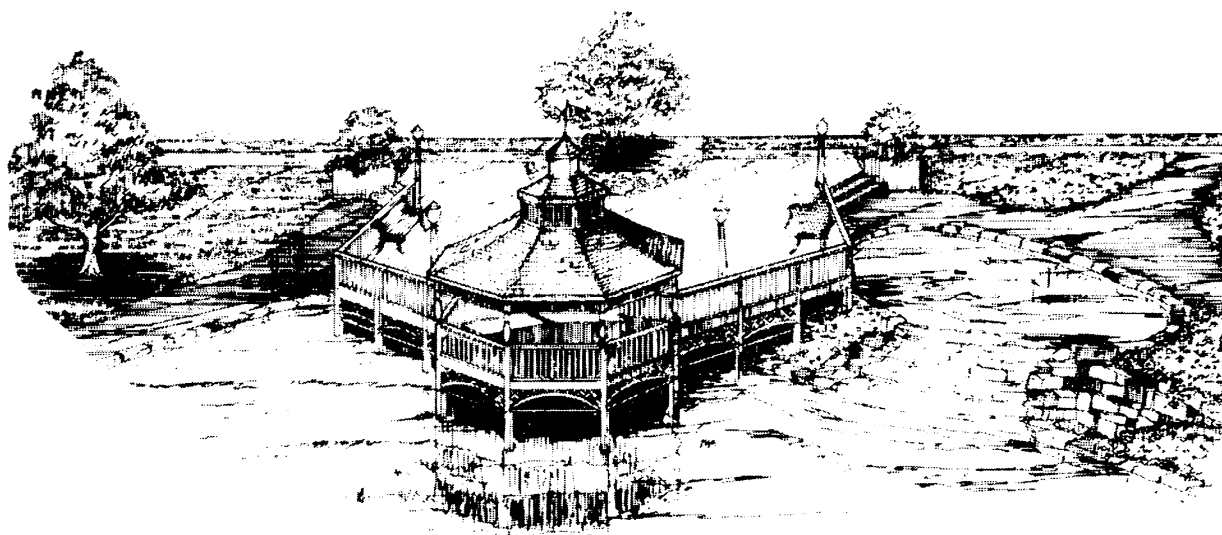

# Cambridge Oaks Homeowners Association Directory

April 4, 2024



To make changes to the Directory please visit: [www.cambridgeoaks.net/directory.htm](http://www.cambridgeoaks.net/directory.htm)

Courtesy of [www.CambridgeOaks.net](http://www.CambridgeOaks.net), the Cambridge Oaks Neighborhood Website.

# Alphabetical Listings

193 Results

Parcel ID ↕	Owner ▾	Property Address ↕	Lot ↕
<a href="#">0739455206</a>	 ANDERSON LLOYD E ETAL	16627 HARNEY ST	104
<a href="#">0739455104</a>	 ANIL BHALLA TRUST	16611 JONES ST	53
<a href="#">0739455332</a>	 ATWELL MICHAEL L ETAL	16523 MASON ST	167
<a href="#">0739455160</a>	 BAHR KENNETH J ETAL	16716 JACKSON ST	81
<a href="#">0739455186</a>	 BARGER JAMES H ETAL	16646 HOWARD CR	94
<a href="#">0739455212</a>	 BEIER SCOTT B ETAL	16725 HARNEY ST	107
<a href="#">0739455174</a>	 BERG SCOTT F ETAL	16605 HOWARD CR	88
<a href="#">0739455034</a>	 BIEBER NOAH ETAL	16617 MARCY ST	18
<a href="#">0739455364</a>	 BOWERS JAMES E ETAL	16517 MARCY ST	183
<a href="#">0739455276</a>	 BRISTOL MARK A ETAL TR	16406 LEAVENWORTH CR	139
<a href="#">0739455288</a>	 BRUNETEAU MITZI M	16435 LEAVENWORTH CR	145
<a href="#">0739455026</a>	 BURKE HENRY W ETAL TR	16626 MASON ST	14
<a href="#">0739455246</a>	 CAMBRIDGE OAKS HOMEOWNERS	16434 JONES CR	124
<a href="#">0739455372</a>	 CAMBRIDGE OAKS HOMEOWNERS	506 S 166 ST	OL1
<a href="#">0739455374</a>	 CAMBRIDGE OAKS HOMEOWNERS	515 S 166 ST	OL2
<a href="#">0739455262</a>	 CARLSON ANNE T ETAL TR	16427 JONES CR	132
<a href="#">0739455084</a>	 CHENG SHIH C ETAL	16728 LEAVENWORTH CR	43
<a href="#">0739455015</a>	 CITY OF OMAHA		8
<a href="#">0739455370</a>	 CITY OF OMAHA	16410 PACIFIC ST	A
<a href="#">0739455380</a>	 CITY OF OMAHA		OL5
<a href="#">0739455272</a>	 CLANTON DENNIS ETAL	16422 LEAVENWORTH CR	137
<a href="#">0739455248</a>	 COCCIA PETER F ETAL	16428 JONES CR	125
<a href="#">0739455322</a>	 COOK TR CHRISTINE J ETAL	16423 MASON ST	162
<a href="#">0739455178</a>	 CUI YING	16623 HOWARD CR	90
<a href="#">0739455020</a>	 CURNYN JOHN M ETAL	16716 MASON CR	11
<a href="#">0739455042</a>	 CURTIS RYAN B ETAL	16717 MARCY CR	22
<a href="#">0739455282</a>	 DARMODY TR JAMES W	16417 LEAVENWORTH CR	142
<a href="#">0739455152</a>	 DAUBERT SEAN H ETAL	16725 JACKSON ST	77
<a href="#">0739455018</a>	 DEITLOFF RUSSELL E ETAL TR	16722 MASON CR	10
<a href="#">0739455184</a>	 DIXON ROGER A ETAL	16641 HOWARD CR	93
<a href="#">0739455376</a>	 DOUGLAS COUNTY	1050 S 166 ST	OL3
<a href="#">0739455378</a>	 DOUGLAS COUNTY		OL4
<a href="#">0739455350</a>	 DOUGLAS DAMON ETAL	16412 MASON ST	176
<a href="#">0739455294</a>	 DROG NICHOLAS J ETAL	16526 MARCY ST	148
<a href="#">0739455214</a>	 DUDZINSKI BERNARD P ETAL	16735 HARNEY ST	108
<a href="#">0739455062</a>	 DUDZINSKI ROBERT J ETAL	16616 MARCY ST	32
<a href="#">0739455128</a>	 DUPREE LIVING TRUST	16644 JONES ST	65
<a href="#">0739455230</a>	 EDEN JON A ETAL	16606 HARNEY ST	116
<a href="#">0739455352</a>	 EICHELBERG ROBERT C ETAL	16406 MASON ST	177
<a href="#">0739455122</a>	 FARROW MICHAEL G ETAL TR	16722 JONES CR	62
<a href="#">0739455060</a>	 FISHER DENNIS A ETAL	16626 MARCY ST	31
<a href="#">0739455194</a>	 FORSTER LAURA ETAL	16622 HOWARD CR	98
<a href="#">0739455066</a>	 FREDRICKSON GRANT ETAL	806 S 166 ST	34
<a href="#">0739455098</a>	 FRIEND PATRICK ETAL	16616 LEAVENWORTH ST	50
<a href="#">0739455304</a>	 FUNK JEFFREY D ETAL	16404 MARCY ST	153
<a href="#">0739455242</a>	 GALLIGAN JOHN D ETAL	555 S 166 ST	122
<a href="#">0739455244</a>	 GARDINER ROBERT S ETAL	565 S 166 ST	123

Parcel ID ↕	Owner ▼	Property Address ↕	Lot ↕
<a href="#">0739455130</a>	GARRELTS BRENDA ETAL	16636 JONES ST	66
<a href="#">0739455140</a>	GARTH PAUL ETAL	16615 JACKSON ST	71
<a href="#">0739455240</a>	GEHRMAN KIMBERLY M	535 S 166 ST	121
<a href="#">0739455202</a>	GILG DANIEL R ETAL	16607 HARNEY ST	102
<a href="#">0739455222</a>	GRAHAM JOE BROWNING ETAL	16706 HARNEY ST	112
<a href="#">0739455134</a>	GRANGER JAMES S ETAL	16616 JONES ST	68
<a href="#">0739455070</a>	GU JING	16627 LEAVENWORTH ST	36
<a href="#">0739455002</a>	HAGNER SCOTTY L ETAL	16617 MASON ST	2
<a href="#">0739455358</a>	HALL JOSEPH A ETAL	16417 MARCY ST	180
<a href="#">0739455038</a>	HAMMOND LAURA M	16637 MARCY ST	20
<a href="#">0739455049</a>	HANSEN ERIC S ETAL	16722 MARCY CR	26
<a href="#">0739455090</a>	HANSON ARLO E ETAL	16706 LEAVENWORTH CR	46
<a href="#">0739455112</a>	HANSON ARLO E ETAL	16707 JONES CR	57
<a href="#">0739456010</a>	HAUSMAN DAVID L ETAL TR	16446 LEAVENWORTH CR	1
<a href="#">0739455220</a>	HAVELKA GREGORY A ETAL	16712 HARNEY ST	111
<a href="#">0739455072</a>	HEDGES DUSTIN D ETAL	16637 LEAVENWORTH ST	37
<a href="#">0739455354</a>	HIGHLEY ADAM ETAL	16405 MARCY ST	178
<a href="#">0739455338</a>	HOLEWINSKI CHRIS ETAL	16524 MASON ST	170
<a href="#">0739455094</a>	HONG LIANG ETAL	16636 LEAVENWORTH ST	48
<a href="#">0739455192</a>	HOPKINS JOHN ETAL	16628 HOWARD CR	97
<a href="#">0739455204</a>	HOWARD STEVEN H ETAL	16617 HARNEY ST	103
<a href="#">0739455300</a>	HRON CHERYL L ETAL	16416 MARCY ST	151
<a href="#">0739455258</a>	HUANG WEI ETAL	16411 JONES CR	130
<a href="#">0739455116</a>	INCONTRO ENTERPRISES LLC	16723 JONES CR	59
<a href="#">0739455312</a>	JANKY MARK S ETAL	921 S 164 ST	157
<a href="#">0739455158</a>	JENSEN ELLIS G ETAL	16726 JACKSON ST	80
<a href="#">0739455182</a>	JOHNSON ERIC D ETAL	16635 HOWARD CR	92
<a href="#">0739455136</a>	JOHNSON RICHARD L ETAL	16606 JONES ST	69
<a href="#">0739455236</a>	JONES THOMAS E ETAL	417 S 166 ST	119
<a href="#">0739455342</a>	JOYCE KEVIN ETAL	16512 MASON ST	172
<a href="#">0739455168</a>	JULIE J PEARCE REV TRUST ETAL	16626 JACKSON ST	85
<a href="#">0739455238</a>	JURISEVIC EDVIN ETAL	427 S 166 ST	120
<a href="#">0739455006</a>	KAHN THOMAS H ETAL	16637 MASON ST	4
<a href="#">0739455110</a>	KATHLEEN M SMITH TRUST	16637 JONES ST	56
<a href="#">0739455189</a>	KEMPKE RODNEY J ETAL		95
<a href="#">0739455190</a>	KEMPKE RODNEY J ETAL	16634 HOWARD CR	96
<a href="#">0739455004</a>	KIMPLE SHARON A ETAL	16627 MASON ST	3
<a href="#">0739455156</a>	KIRSHENBAUM TR JOAN M	16736 JACKSON ST	79
<a href="#">0739455166</a>	KOLA BETTY	16636 JACKSON ST	84
<a href="#">0739455148</a>	KOLIOPOULOS NIKOLAOS ETAL	16705 JACKSON ST	75
<a href="#">0739455334</a>	KOROLCHUK JR THEODORE ETAL TR	16529 MASON ST	168
<a href="#">0739455146</a>	KRISHNAKUMAR SAJINESH K ETAL	16645 JACKSON ST	74
<a href="#">0739455208</a>	KROON FAMILY JOINT TRUST	16637 HARNEY ST	105
<a href="#">0739455030</a>	KUNWAR MONIKA ETAL	16606 MASON ST	16
<a href="#">0739455138</a>	LEE CRAIG ETAL	16605 JACKSON ST	70
<a href="#">0739455234</a>	LEWIS WILLIAM H ETAL	407 S 166 ST	118
<a href="#">0739455368</a>	LUNDGREN SCOTT ETAL	16537 MARCY ST	185
<a href="#">0739455048</a>	LYNCH SEAN A ETAL	16728 MARCY CR	25
<a href="#">0739455324</a>	MANGANARO CAROL	16429 MASON ST	163
<a href="#">0739455074</a>	MARDESEN CHAD P ETAL	16647 LEAVENWORTH ST	38
<a href="#">0739455187</a>	MARY R THEISEN LIVING TR ETAL	16640 HOWARD CR	95
<a href="#">0739455132</a>	MASON AARON J ETAL	16626 JONES ST	67
<a href="#">0739455268</a>	MCCOLLUM JAMES J ETAL	16438 LEAVENWORTH CR	135

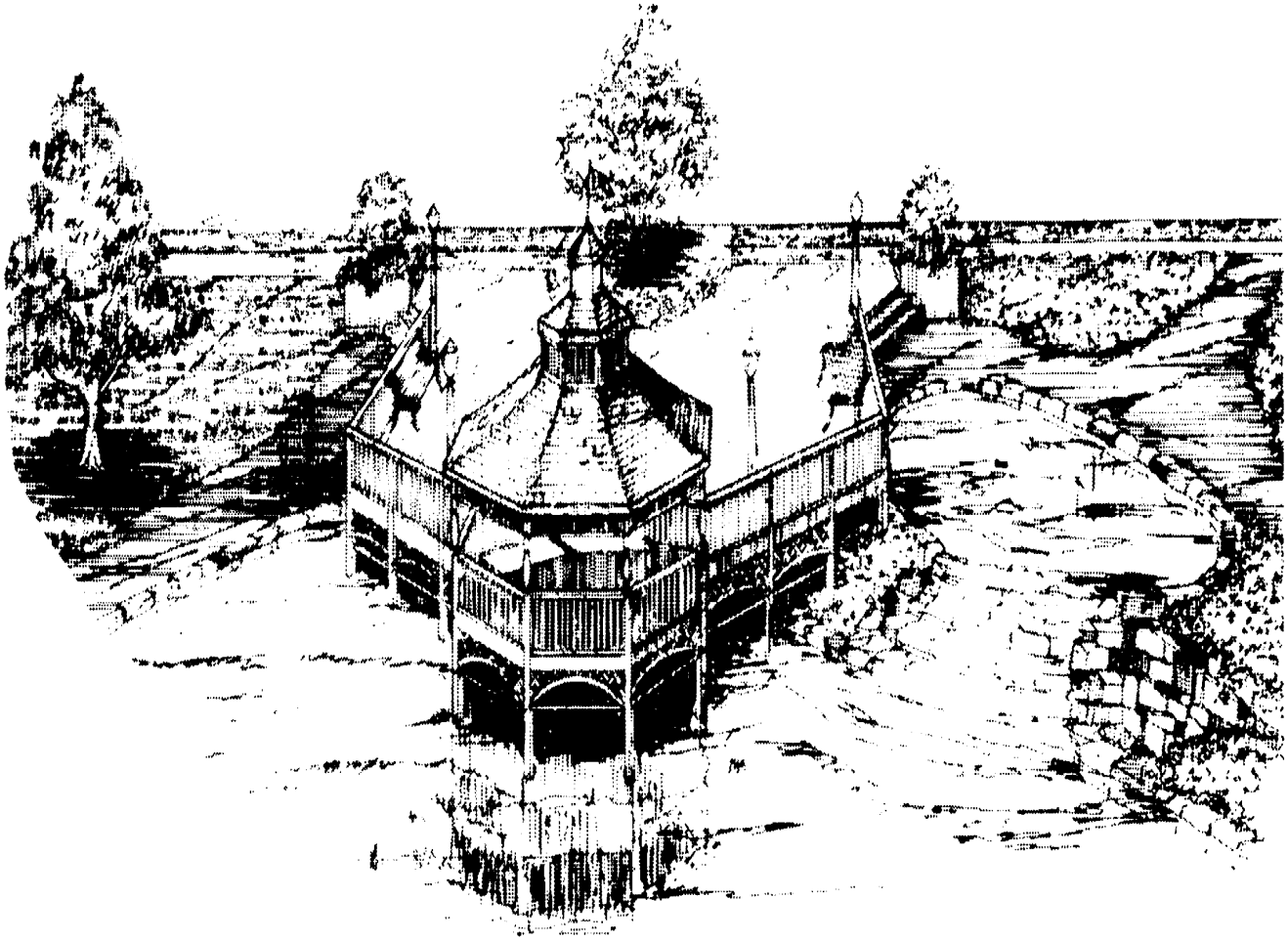

Parcel ID ↕	Owner ▼	Property Address ↕	Lot ↕
<a href="#">0739455196</a>	MCGARRY BRIAN ETAL	16616 HOWARD CR	99
<a href="#">0739455078</a>	MCGILICK MICHAEL W ETAL	16717 LEAVENWORTH CR	40
<a href="#">0739455024</a>	MCSHANNON NICK ETAL	16636 MASON ST	13
<a href="#">0739455362</a>	MEISTER ARNOLD H ETAL	16511 MARCY ST	182
<a href="#">0739455086</a>	MEYER GALEN M	16722 LEAVENWORTH CR	44
<a href="#">0739455326</a>	MEYERS JEFFREY P ETAL	16505 MASON ST	164
<a href="#">0739455088</a>	MILLER ANDREW ETAL	16716 LEAVENWORTH CR	45
<a href="#">0739455124</a>	MOBERG TR JEFFREY E	16716 JONES CR	63
<a href="#">0739455096</a>	MORNAN AMY M ETAL	16626 LEAVENWORTH ST	49
<a href="#">0739455056</a>	MORNAN WILLIAM	16644 MARCY ST	29
<a href="#">0739455336</a>	MOSS BRUCE E ETAL	16530 MASON ST	169
<a href="#">0739455100</a>	MULLEN ROCHELLE A	16606 LEAVENWORTH ST	51
<a href="#">0739455284</a>	MURANTE MELISSA ETAL	16423 LEAVENWORTH CR	143
<a href="#">0739455308</a>	MURRAY STEVEN ETAL	909 S 164 ST	155
<a href="#">0739455016</a>	NICHOLAS SCOTT B ETAL	16728 MASON CR	9
<a href="#">0739455044</a>	NORTHERN TERRITORY HOLDINGS LL	16723 MARCY CR	23
<a href="#">0739455210</a>	NUNN LEON	16715 HARNEY ST	106

Parcel ID ↕	Owner ▼	Property Address ↕	Lot ↕
<a href="#">0739455316</a>	OGUNLEYE AFOLABI O ETAL	16405 MASON ST	159
<a href="#">0739455348</a>	OKELL JAMES E ETAL	16418 MASON ST	175
<a href="#">0739455012</a>	OLSEN JOHN L ETAL	16723 MASON CR	7
<a href="#">0739455172</a>	OSBORNE COLVILLE E ETAL	16606 JACKSON ST	87
<a href="#">0739455226</a>	OSTDIEK FREDERICK J ETAL	16626 HARNEY ST	114
<a href="#">0739455356</a>	PANTOS DAVID ETAL	16411 MARCY ST	179
<a href="#">0739456012</a>	PARKS ERICA R ETAL	16435 JONES CR	2
<a href="#">0739455176</a>	PATRICK J WILLIAMS ETAL TRUST	16617 HOWARD CR	89
<a href="#">0739455344</a>	PERRY GREG A ETAL	16506 MASON ST	173
<a href="#">0739455274</a>	PETERSON HAROLD E ETAL	16412 LEAVENWORTH CR	138
<a href="#">0739455256</a>	PNL TRUST ETAL	16405 JONES CR	129
<a href="#">0739455328</a>	POTTER DAVID E ETAL	16511 MASON ST	165
<a href="#">0739455068</a>	PRIBYL CHARLES MICHAEL ETAL	16617 LEAVENWORTH ST	35
<a href="#">0739455218</a>	PUGSLEY 4 CHARLES S ETAL	16722 HARNEY ST	110
<a href="#">0739455082</a>	QUANDAHL MARK C ETAL TR	16729 LEAVENWORTH CR	42
<a href="#">0739455106</a>	RAYMOND DAVE ETAL	16619 JONES ST	54
<a href="#">0739455120</a>	REILLY-MOUNTJOY SHEILA	16728 JONES CR	61
<a href="#">0739455102</a>	RICHT TIMOTHY P ETAL	16605 JONES ST	52
<a href="#">0739455270</a>	RIES BARBARA J ETAL	16432 LEAVENWORTH CR	136
<a href="#">0739455008</a>	ROBBIN & JANET ROCK RV FAM TR	16707 MASON CR	5
<a href="#">0739455198</a>	ROBERT AND ANN STRATTON TRUST	16606 HOWARD CR	100
<a href="#">0739455228</a>	RODGERS LAURA ETAL	16616 HARNEY ST	115
<a href="#">0739455022</a>	ROE GRETCHEN G	16706 MASON CR	12
<a href="#">0739455154</a>	ROMAN HENRY ETAL	16735 JACKSON ST	78
<a href="#">0739455232</a>	RON & CHRISTY HUBER TRUST ETAL	345 S 166 ST	117
<a href="#">0739455108</a>	RONSHAUGEN SCOTT ETAL	16627 JONES ST	55
<a href="#">0739455054</a>	ROSENBERRY CARRIE L ETAL	16706 MARCY CR	28
<a href="#">0739455320</a>	RUFF STEPHEN W ETAL TR	16417 MASON ST	161
<a href="#">0739455144</a>	RUGE DOUGLAS W ETAL	16635 JACKSON ST	73
<a href="#">0739455216</a>	SACKETT JAMES R ETAL	16732 HARNEY ST	109
<a href="#">0739455200</a>	SALKIN MIKE	418 S 166 ST	101
<a href="#">0739455318</a>	SALMAN SAQER	16411 MASON ST	160
<a href="#">0739455076</a>	SATYAL BIPIN ETAL	16707 LEAVENWORTH CR	39
<a href="#">0739455150</a>	SCHAFF FAMILY TRUST ETAL	16715 JACKSON ST	76
<a href="#">0739455080</a>	SCHILTZ DAVID A ETAL	16723 LEAVENWORTH CR	41
<a href="#">0739455046</a>	SCHOLZ STEPHANIE L ETAL	16729 MARCY CR	24
<a href="#">0739455366</a>	SCHRADER BRIAN A	16527 MARCY ST	184
<a href="#">0739455053</a>	SHANEHSAZZADEH ABOLFAZL ETAL	16716 MARCY CR	27
<a href="#">0739455330</a>	SHARP JOHN A ETAL	16517 MASON ST	166
<a href="#">0739455252</a>	SHERRY E LOSEKE TRUST ETAL	16416 JONES CR	127
<a href="#">0739455306</a>	SILVA MARIO	903 S 164 ST	154
<a href="#">0739455010</a>	SINGH SHAILENDER ETAL	16717 MASON CR	6
<a href="#">0739455296</a>	SLAUGHTER RUSTIN ETAL	16516 MARCY ST	149
<a href="#">0739455028</a>	SMITH NORRIS M ETAL TR	16616 MASON ST	15
<a href="#">0739455164</a>	SNYDER AMANDA ETAL	16646 JACKSON ST	83
<a href="#">0739455280</a>	SORRENTINO JOSEPH ETAL	16411 LEAVENWORTH CR	141
<a href="#">0739455292</a>	SPRINGSTED PAUL ETAL	16536 MARCY ST	147
<a href="#">0739455310</a>	STARR BRENT D ETAL	915 S 164 ST	156
<a href="#">0739455298</a>	STEINHAUSEN ARTHUR H ETAL	16506 MARCY ST	150
<a href="#">0739455058</a>	STEJSKAL MATTHEW J ETAL	16634 MARCY ST	30
<a href="#">0739455254</a>	STEPHENSON SHANE ETAL	16406 JONES CR	128
<a href="#">0739455142</a>	STOCKFELD MATTHEW ETAL	16625 JACKSON ST	72
<a href="#">0739455162</a>	STRAWHECKER NICHOLAS ETAL	16706 JACKSON ST	82

Parcel ID ↕	Owner ▼	Property Address ↕	Lot ↕
 <a href="#">0739455224</a>	 STRONG RYAN C ETAL	16636 HARNEY ST	113
 <a href="#">0739455260</a>	 THIEMANN ZACHARY ETAL	16417 JONES CR	131
 <a href="#">0739455114</a>	 THOMAS A FRANCO LIV TRUST ETAL	16717 JONES CR	58
 <a href="#">0739455290</a>	 THOMAS R & LEE A PORTER ETAL	16445 LEAVENWORTH CR	146
 <a href="#">0739455032</a>	 TOMPKINS TR JANICE I	16607 MARCY ST	17
 <a href="#">0739455346</a>	 TRAUERNICHT ROBERT J ETAL	16428 MASON ST	174
 <a href="#">0739455092</a>	 VAVRICEK JEFFREY S ETAL	16646 LEAVENWORTH ST	47
 <a href="#">0739455036</a>	 VELASCO JR ETALAL IVAN	16627 MARCY ST	19
 <a href="#">0739455118</a>	 VIAREGGER TERRANCE M	16729 JONES CR	60
 <a href="#">0739455064</a>	 WALTER DANIEL D ETAL	16606 MARCY ST	33
 <a href="#">0739455286</a>	 WANG SAN M ETAL	16429 LEAVENWORTH CR	144
 <a href="#">0739455250</a>	 WARREN TREVOR ETAL	16422 JONES CR	126
 <a href="#">0739455180</a>	 WATERS CLARENCE E ETAL	16629 HOWARD CR	91
 <a href="#">0739455000</a>	 WAYNE & SHIRIN TAYLOR TR ETAL	16607 MASON ST	1
 <a href="#">0739455302</a>	 WEEDER KURT ETAL	16410 MARCY ST	152
 <a href="#">0739455170</a>	 WEHNER MARK T ETAL	16616 JACKSON ST	86
 <a href="#">0739455017</a>	 WELKER KEVIN P ETAL TR	16729 MASON CR	8
 <a href="#">0739455360</a>	 WILLIAMS STEVEN E ETAL	16505 MARCY ST	181
 <a href="#">0739455314</a>	 YOSTEN MARK ETAL	927 S 164 ST	158
 <a href="#">0739455126</a>	 YOUNG MARTIN A ETAL	16706 JONES CR	64
 <a href="#">0739455340</a>	 ZAKI EZZAT H ETAL	16518 MASON ST	171
 <a href="#">0739455040</a>	 ZEHNACKER RICHARD A ETAL TR	16707 MARCY CR	21
 <a href="#">0739455278</a>	 ZETTERMAN EMILY J ETAL TR	16405 LEAVENWORTH CR	140

# Listings by Lot Number

193 Results

Parcel ID ▾	Owner ⇅	Property Address ⇅	Lot ⇅
<a href="#">0739455000</a>	WAYNE & SHIRIN TAYLOR TR ETAL	16607 MASON ST	1
<a href="#">0739455002</a>	HAGNER SCOTTY L ETAL	16617 MASON ST	2
<a href="#">0739455004</a>	KIMPLE SHARON A ETAL	16627 MASON ST	3
<a href="#">0739455006</a>	KAHN THOMAS H ETAL	16637 MASON ST	4
<a href="#">0739455008</a>	ROBBIN & JANET ROCK RV FAM TR	16707 MASON CR	5
<a href="#">0739455010</a>	SINGH SHAILENDER ETAL	16717 MASON CR	6
<a href="#">0739455012</a>	OLSEN JOHN L ETAL	16723 MASON CR	7
<a href="#">0739455015</a>	CITY OF OMAHA		8
<a href="#">0739455016</a>	NICHOLAS SCOTT B ETAL	16728 MASON CR	9
<a href="#">0739455017</a>	WELKER KEVIN P ETAL TR	16729 MASON CR	8
<a href="#">0739455018</a>	DEITLOFF RUSSELL E ETAL TR	16722 MASON CR	10
<a href="#">0739455020</a>	CURNYN JOHN M ETAL	16716 MASON CR	11
<a href="#">0739455022</a>	ROE GRETCHEN G	16706 MASON CR	12
<a href="#">0739455024</a>	MCSHANNON NICK ETAL	16636 MASON ST	13
<a href="#">0739455026</a>	BURKE HENRY W ETAL TR	16626 MASON ST	14
<a href="#">0739455028</a>	SMITH NORRIS M ETAL TR	16616 MASON ST	15
<a href="#">0739455030</a>	KUNWAR MONIKA ETAL	16606 MASON ST	16
<a href="#">0739455032</a>	TOMPKINS TR JANICE I	16607 MARCY ST	17
<a href="#">0739455034</a>	BIEBER NOAH ETAL	16617 MARCY ST	18
<a href="#">0739455036</a>	VELASCO JR ETALAL IVAN	16627 MARCY ST	19
<a href="#">0739455038</a>	HAMMOND LAURA M	16637 MARCY ST	20
<a href="#">0739455040</a>	ZEHNACKER RICHARD A ETAL TR	16707 MARCY CR	21
<a href="#">0739455042</a>	CURTIS RYAN B ETAL	16717 MARCY CR	22
<a href="#">0739455044</a>	NORTHERN TERRITORY HOLDINGS LL	16723 MARCY CR	23
<a href="#">0739455046</a>	SCHOLZ STEPHANIE L ETAL	16729 MARCY CR	24
<a href="#">0739455048</a>	LYNCH SEAN A ETAL	16728 MARCY CR	25
<a href="#">0739455049</a>	HANSEN ERIC S ETAL	16722 MARCY CR	26
<a href="#">0739455053</a>	SHANEHSAZZADEH ABOLFAZL ETAL	16716 MARCY CR	27
<a href="#">0739455054</a>	ROSENBERRY CARRIE L ETAL	16706 MARCY CR	28
<a href="#">0739455056</a>	MORNAN WILLIAM	16644 MARCY ST	29
<a href="#">0739455058</a>	STEJSKAL MATTHEW J ETAL	16634 MARCY ST	30
<a href="#">0739455060</a>	FISHER DENNIS A ETAL	16626 MARCY ST	31
<a href="#">0739455062</a>	DUDZINSKI ROBERT J ETAL	16616 MARCY ST	32
<a href="#">0739455064</a>	WALTER DANIEL D ETAL	16606 MARCY ST	33
<a href="#">0739455066</a>	FREDRICKSON GRANT ETAL	806 S 166 ST	34
<a href="#">0739455068</a>	PRIBYL CHARLES MICHAEL ETAL	16617 LEAVENWORTH ST	35
<a href="#">0739455070</a>	GU JING	16627 LEAVENWORTH ST	36
<a href="#">0739455072</a>	HEDGES DUSTIN D ETAL	16637 LEAVENWORTH ST	37
<a href="#">0739455074</a>	MARDESEN CHAD P ETAL	16647 LEAVENWORTH ST	38
<a href="#">0739455076</a>	SATYAL BIPIN ETAL	16707 LEAVENWORTH CR	39
<a href="#">0739455078</a>	MCGILLICK MICHAEL W ETAL	16717 LEAVENWORTH CR	40
<a href="#">0739455080</a>	SCHILTZ DAVID A ETAL	16723 LEAVENWORTH CR	41
<a href="#">0739455082</a>	QUANDAHL MARK C ETAL TR	16729 LEAVENWORTH CR	42
<a href="#">0739455084</a>	CHENG SHIH C ETAL	16728 LEAVENWORTH CR	43
<a href="#">0739455086</a>	MEYER GALEN M	16722 LEAVENWORTH CR	44
<a href="#">0739455088</a>	MILLER ANDREW ETAL	16716 LEAVENWORTH CR	45
<a href="#">0739455090</a>	HANSON ARLO E ETAL	16706 LEAVENWORTH CR	46

Parcel ID ▾	Owner ↕	Property Address ↕	Lot ↕
<a href="#">0739455092</a>	VAVRICEK JEFFREY S ETAL	16646 LEAVENWORTH ST	47
<a href="#">0739455094</a>	HONG LIANG ETAL	16636 LEAVENWORTH ST	48
<a href="#">0739455096</a>	MORNAN AMY M ETAL	16626 LEAVENWORTH ST	49
<a href="#">0739455098</a>	FRIEND PATRICK ETAL	16616 LEAVENWORTH ST	50
<a href="#">0739455100</a>	MULLEN ROCHELLE A	16606 LEAVENWORTH ST	51
<a href="#">0739455102</a>	RICHT TIMOTHY P ETAL	16605 JONES ST	52
<a href="#">0739455104</a>	ANIL BHALLA TRUST	16611 JONES ST	53
<a href="#">0739455106</a>	RAYMOND DAVE ETAL	16619 JONES ST	54
<a href="#">0739455108</a>	RONSHAUGEN SCOTT ETAL	16627 JONES ST	55
<a href="#">0739455110</a>	KATHLEEN M SMITH TRUST	16637 JONES ST	56
<a href="#">0739455112</a>	HANSON ARLO E ETAL	16707 JONES CR	57
<a href="#">0739455114</a>	THOMAS A FRANCO LIV TRUST ETAL	16717 JONES CR	58
<a href="#">0739455116</a>	INCONTRO ENTERPRISES LLC	16723 JONES CR	59
<a href="#">0739455118</a>	VIEREGGER TERRANCE M	16729 JONES CR	60
<a href="#">0739455120</a>	REILLY-MOUNTJOY SHEILA	16728 JONES CR	61
<a href="#">0739455122</a>	FARROW MICHAEL G ETAL TR	16722 JONES CR	62
<a href="#">0739455124</a>	MOBERG TR JEFFREY E	16716 JONES CR	63
<a href="#">0739455126</a>	YOUNG MARTIN A ETAL	16706 JONES CR	64
<a href="#">0739455128</a>	DUPREE LIVING TRUST	16644 JONES ST	65
<a href="#">0739455130</a>	GARRELTS BRENDA ETAL	16636 JONES ST	66
<a href="#">0739455132</a>	MASON AARON J ETAL	16626 JONES ST	67
<a href="#">0739455134</a>	GRANGER JAMES S ETAL	16616 JONES ST	68
<a href="#">0739455136</a>	JOHNSON RICHARD L ETAL	16606 JONES ST	69
<a href="#">0739455138</a>	LEE CRAIG ETAL	16605 JACKSON ST	70
<a href="#">0739455140</a>	GARTH PAUL ETAL	16615 JACKSON ST	71
<a href="#">0739455142</a>	STOCKFELD MATTHEW ETAL	16625 JACKSON ST	72
<a href="#">0739455144</a>	RUGE DOUGLAS W ETAL	16635 JACKSON ST	73
<a href="#">0739455146</a>	KRISHNAKUMAR SAJINESH K ETAL	16645 JACKSON ST	74
<a href="#">0739455148</a>	KOLIOPOULOS NIKOLAOS ETAL	16705 JACKSON ST	75
<a href="#">0739455150</a>	SCHAFF FAMILY TRUST ETAL	16715 JACKSON ST	76
<a href="#">0739455152</a>	DAUBERT SEAN H ETAL	16725 JACKSON ST	77
<a href="#">0739455154</a>	ROMAN HENRY ETAL	16735 JACKSON ST	78
<a href="#">0739455156</a>	KIRSHENBAUM TR JOAN M	16736 JACKSON ST	79
<a href="#">0739455158</a>	JENSEN ELLIS G ETAL	16726 JACKSON ST	80
<a href="#">0739455160</a>	BAHR KENNETH J ETAL	16716 JACKSON ST	81
<a href="#">0739455162</a>	STRAWHECKER NICHOLAS ETAL	16706 JACKSON ST	82
<a href="#">0739455164</a>	SNYDER AMANDA ETAL	16646 JACKSON ST	83
<a href="#">0739455166</a>	KOLA BETTY	16636 JACKSON ST	84
<a href="#">0739455168</a>	JULIE J PEARCE REV TRUST ETAL	16626 JACKSON ST	85
<a href="#">0739455170</a>	WEHNER MARK T ETAL	16616 JACKSON ST	86
<a href="#">0739455172</a>	OSBORNE COLVILLE E ETAL	16606 JACKSON ST	87
<a href="#">0739455174</a>	BERG SCOTT F ETAL	16605 HOWARD CR	88
<a href="#">0739455176</a>	PATRICK J WILLIAMS ETAL TRUST	16617 HOWARD CR	89
<a href="#">0739455178</a>	CUI YING	16623 HOWARD CR	90
<a href="#">0739455180</a>	WATERS CLARENCE E ETAL	16629 HOWARD CR	91
<a href="#">0739455182</a>	JOHNSON ERIC D ETAL	16635 HOWARD CR	92
<a href="#">0739455184</a>	DIXON ROGER A ETAL	16641 HOWARD CR	93
<a href="#">0739455186</a>	BARGER JAMES H ETAL	16646 HOWARD CR	94
<a href="#">0739455187</a>	MARY R THEISEN LIVING TR ETAL	16640 HOWARD CR	95
<a href="#">0739455189</a>	KEMPKE RODNEY J ETAL		95
<a href="#">0739455190</a>	KEMPKE RODNEY J ETAL	16634 HOWARD CR	96
<a href="#">0739455192</a>	HOPKINS JOHN ETAL	16628 HOWARD CR	97
<a href="#">0739455194</a>	FORSTER LAURA ETAL	16622 HOWARD CR	98

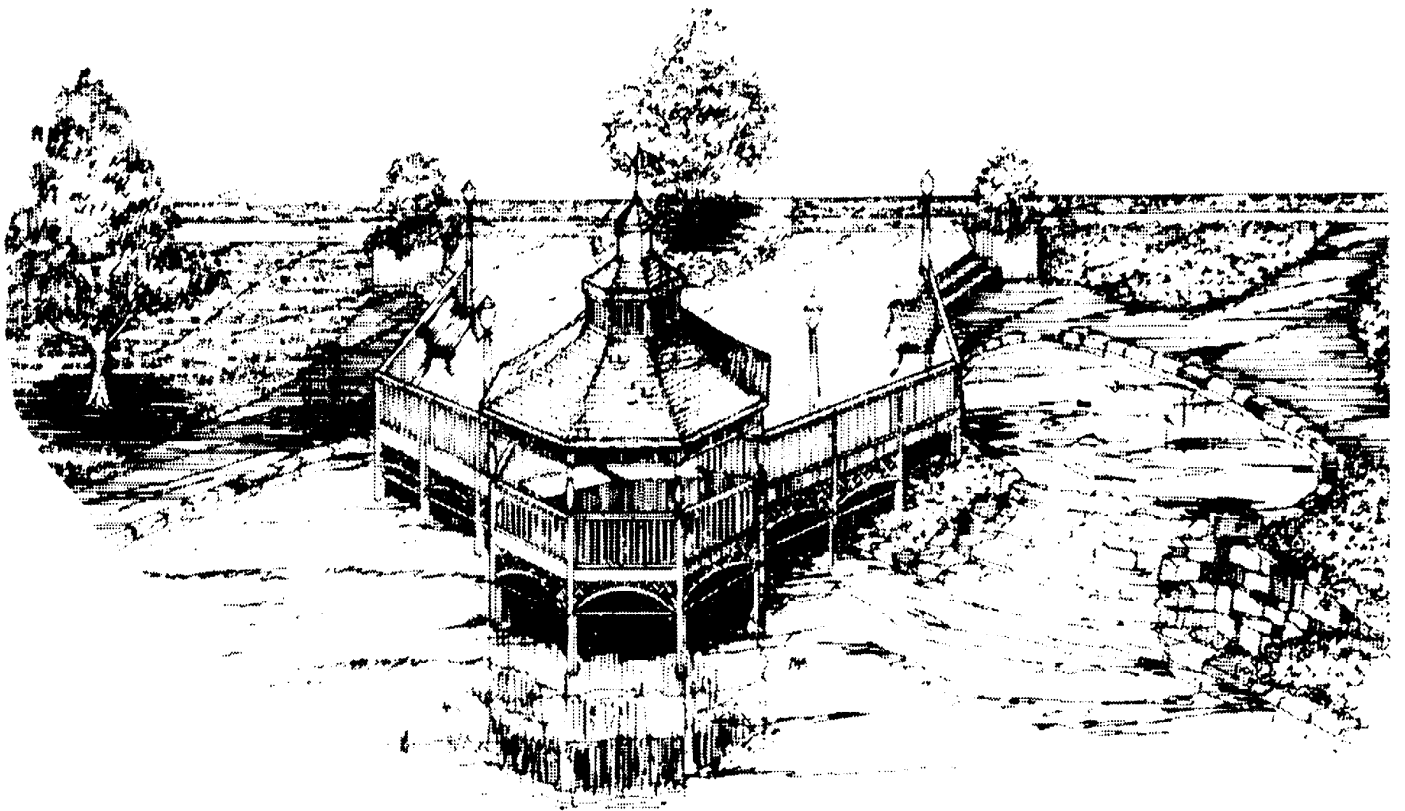

Parcel ID ▾	Owner ⇅	Property Address ⇅	Lot ⇅
<a href="#">0739455196</a>	MCGARRY BRIAN ETAL	16616 HOWARD CR	99
<a href="#">0739455198</a>	ROBERT AND ANN STRATTON TRUST	16606 HOWARD CR	100
<a href="#">0739455200</a>	SALKIN MIKE	418 S 166 ST	101
<a href="#">0739455202</a>	GILG DANIEL R ETAL	16607 HARNEY ST	102
<a href="#">0739455204</a>	HOWARD STEVEN H ETAL	16617 HARNEY ST	103
<a href="#">0739455206</a>	ANDERSON LLOYD E ETAL	16627 HARNEY ST	104
<a href="#">0739455208</a>	KROON FAMILY JOINT TRUST	16637 HARNEY ST	105
<a href="#">0739455210</a>	NUNN LEON	16715 HARNEY ST	106
<a href="#">0739455212</a>	BEIER SCOTT B ETAL	16725 HARNEY ST	107
<a href="#">0739455214</a>	DUDZINSKI BERNARD P ETAL	16735 HARNEY ST	108
<a href="#">0739455216</a>	SACKETT JAMES R ETAL	16732 HARNEY ST	109
<a href="#">0739455218</a>	PUGSLEY 4 CHARLES S ETAL	16722 HARNEY ST	110
<a href="#">0739455220</a>	HAVELKA GREGORY A ETAL	16712 HARNEY ST	111
<a href="#">0739455222</a>	GRAHAM JOE BROWNING ETAL	16706 HARNEY ST	112
<a href="#">0739455224</a>	STRONG RYAN C ETAL	16636 HARNEY ST	113
<a href="#">0739455226</a>	OSTDIEK FREDERICK J ETAL	16626 HARNEY ST	114
<a href="#">0739455228</a>	RODGERS LAURA ETAL	16616 HARNEY ST	115

Parcel ID ▾	Owner ↕	Property Address ↕	Lot ↕
<a href="#">0739455230</a>	EDEN JON A ETAL	16606 HARNEY ST	116
<a href="#">0739455232</a>	RON & CHRISTY HUBER TRUST ETAL	345 S 166 ST	117
<a href="#">0739455234</a>	LEWIS WILLIAM H ETAL	407 S 166 ST	118
<a href="#">0739455236</a>	JONES THOMAS E ETAL	417 S 166 ST	119
<a href="#">0739455238</a>	JURISEVIC EDVIN ETAL	427 S 166 ST	120
<a href="#">0739455240</a>	GEHRMAN KIMBERLY M	535 S 166 ST	121
<a href="#">0739455242</a>	GALLIGAN JOHN D ETAL	555 S 166 ST	122
<a href="#">0739455244</a>	GARDINER ROBERT S ETAL	565 S 166 ST	123
<a href="#">0739455246</a>	CAMBRIDGE OAKS HOMEOWNERS	16434 JONES CR	124
<a href="#">0739455248</a>	COCCIA PETER F ETAL	16428 JONES CR	125
<a href="#">0739455250</a>	WARREN TREVOR ETAL	16422 JONES CR	126
<a href="#">0739455252</a>	SHERRY E LOSEKE TRUST ETAL	16416 JONES CR	127
<a href="#">0739455254</a>	STEPHENSON SHANE ETAL	16406 JONES CR	128
<a href="#">0739455256</a>	PNL TRUST ETAL	16405 JONES CR	129
<a href="#">0739455258</a>	HUANG WEI ETAL	16411 JONES CR	130
<a href="#">0739455260</a>	THIEMANN ZACHARY ETAL	16417 JONES CR	131
<a href="#">0739455262</a>	CARLSON ANNE T ETAL TR	16427 JONES CR	132
<a href="#">0739455268</a>	MCCOLLUM JAMES J ETAL	16438 LEAVENWORTH CR	135
<a href="#">0739455270</a>	RIES BARBARA J ETAL	16432 LEAVENWORTH CR	136
<a href="#">0739455272</a>	CLANTON DENNIS ETAL	16422 LEAVENWORTH CR	137
<a href="#">0739455274</a>	PETERSON HAROLD E ETAL	16412 LEAVENWORTH CR	138
<a href="#">0739455276</a>	BRISTOL MARK A ETAL TR	16406 LEAVENWORTH CR	139
<a href="#">0739455278</a>	ZETTERMAN EMILY J ETAL TR	16405 LEAVENWORTH CR	140
<a href="#">0739455280</a>	SORRENTINO JOSEPH ETAL	16411 LEAVENWORTH CR	141
<a href="#">0739455282</a>	DARMODY TR JAMES W	16417 LEAVENWORTH CR	142
<a href="#">0739455284</a>	MURANTE MELISSA ETAL	16423 LEAVENWORTH CR	143
<a href="#">0739455286</a>	WANG SAN M ETAL	16429 LEAVENWORTH CR	144
<a href="#">0739455288</a>	BRUNETEAU MITZI M	16435 LEAVENWORTH CR	145
<a href="#">0739455290</a>	THOMAS R & LEE A PORTER ETAL	16445 LEAVENWORTH CR	146
<a href="#">0739455292</a>	SPRINGSTED PAUL ETAL	16536 MARCY ST	147
<a href="#">0739455294</a>	DROG NICHOLAS J ETAL	16526 MARCY ST	148
<a href="#">0739455296</a>	SLAUGHTER RUSTIN ETAL	16516 MARCY ST	149
<a href="#">0739455298</a>	STEINHAUSEN ARTHUR H ETAL	16506 MARCY ST	150
<a href="#">0739455300</a>	HRON CHERYL L ETAL	16416 MARCY ST	151
<a href="#">0739455302</a>	WEEDER KURT ETAL	16410 MARCY ST	152
<a href="#">0739455304</a>	FUNK JEFFREY D ETAL	16404 MARCY ST	153
<a href="#">0739455306</a>	SILVA MARIO	903 S 164 ST	154
<a href="#">0739455308</a>	MURRAY STEVEN ETAL	909 S 164 ST	155
<a href="#">0739455310</a>	STARR BRENT D ETAL	915 S 164 ST	156
<a href="#">0739455312</a>	JANKY MARK S ETAL	921 S 164 ST	157
<a href="#">0739455314</a>	YOSTEN MARK ETAL	927 S 164 ST	158
<a href="#">0739455316</a>	OGUNLEYE AFOLABI O ETAL	16405 MASON ST	159
<a href="#">0739455318</a>	SALMAN SAQER	16411 MASON ST	160
<a href="#">0739455320</a>	RUFF STEPHEN W ETAL TR	16417 MASON ST	161
<a href="#">0739455322</a>	COOK TR CHRISTINE J ETAL	16423 MASON ST	162
<a href="#">0739455324</a>	MANGANARO CAROL	16429 MASON ST	163
<a href="#">0739455326</a>	MEYERS JEFFREY P ETAL	16505 MASON ST	164
<a href="#">0739455328</a>	POTTER DAVID E ETAL	16511 MASON ST	165
<a href="#">0739455330</a>	SHARP JOHN A ETAL	16517 MASON ST	166
<a href="#">0739455332</a>	ATWELL MICHAEL L ETAL	16523 MASON ST	167
<a href="#">0739455334</a>	KOROLCHUK JR THEODORE ETAL TR	16529 MASON ST	168
<a href="#">0739455336</a>	MOSS BRUCE E ETAL	16530 MASON ST	169
<a href="#">0739455338</a>	HOLEWINSKI CHRIS ETAL	16524 MASON ST	170

Parcel ID ▾	Owner ⇅	Property Address ⇅	Lot ⇅
<a href="#">0739455340</a>	ZAKI EZZAT H ETAL	16518 MASON ST	171
<a href="#">0739455342</a>	JOYCE KEVIN ETAL	16512 MASON ST	172
<a href="#">0739455344</a>	PERRY GREG A ETAL	16506 MASON ST	173
<a href="#">0739455346</a>	TRAUERNICHT ROBERT J ETAL	16428 MASON ST	174
<a href="#">0739455348</a>	OKELL JAMES E ETAL	16418 MASON ST	175
<a href="#">0739455350</a>	DOUGLAS DAMON ETAL	16412 MASON ST	176
<a href="#">0739455352</a>	EICHELBERG ROBERT C ETAL	16406 MASON ST	177
<a href="#">0739455354</a>	HIGHLEY ADAM ETAL	16405 MARCY ST	178
<a href="#">0739455356</a>	PANTOS DAVID ETAL	16411 MARCY ST	179
<a href="#">0739455358</a>	HALL JOSEPH A ETAL	16417 MARCY ST	180
<a href="#">0739455360</a>	WILLIAMS STEVEN E ETAL	16505 MARCY ST	181
<a href="#">0739455362</a>	MEISTER ARNOLD H ETAL	16511 MARCY ST	182
<a href="#">0739455364</a>	BOWERS JAMES E ETAL	16517 MARCY ST	183
<a href="#">0739455366</a>	SCHRADER BRIAN A	16527 MARCY ST	184
<a href="#">0739455368</a>	LUNDGREN SCOTT ETAL	16537 MARCY ST	185
<a href="#">0739455370</a>	CITY OF OMAHA	16410 PACIFIC ST	A
<a href="#">0739455372</a>	CAMBRIDGE OAKS HOMEOWNERS	506 S 166 ST	OL1
<a href="#">0739455374</a>	CAMBRIDGE OAKS HOMEOWNERS	515 S 166 ST	OL2
<a href="#">0739455376</a>	DOUGLAS COUNTY	1050 S 166 ST	OL3
<a href="#">0739455378</a>	DOUGLAS COUNTY		OL4
<a href="#">0739455380</a>	CITY OF OMAHA		OL5
<a href="#">0739456010</a>	HAUSMAN DAVID L ETAL TR	16446 LEAVENWORTH CR	1
<a href="#">0739456012</a>	PARKS ERICA R ETAL	16435 JONES CR	2

193 Results

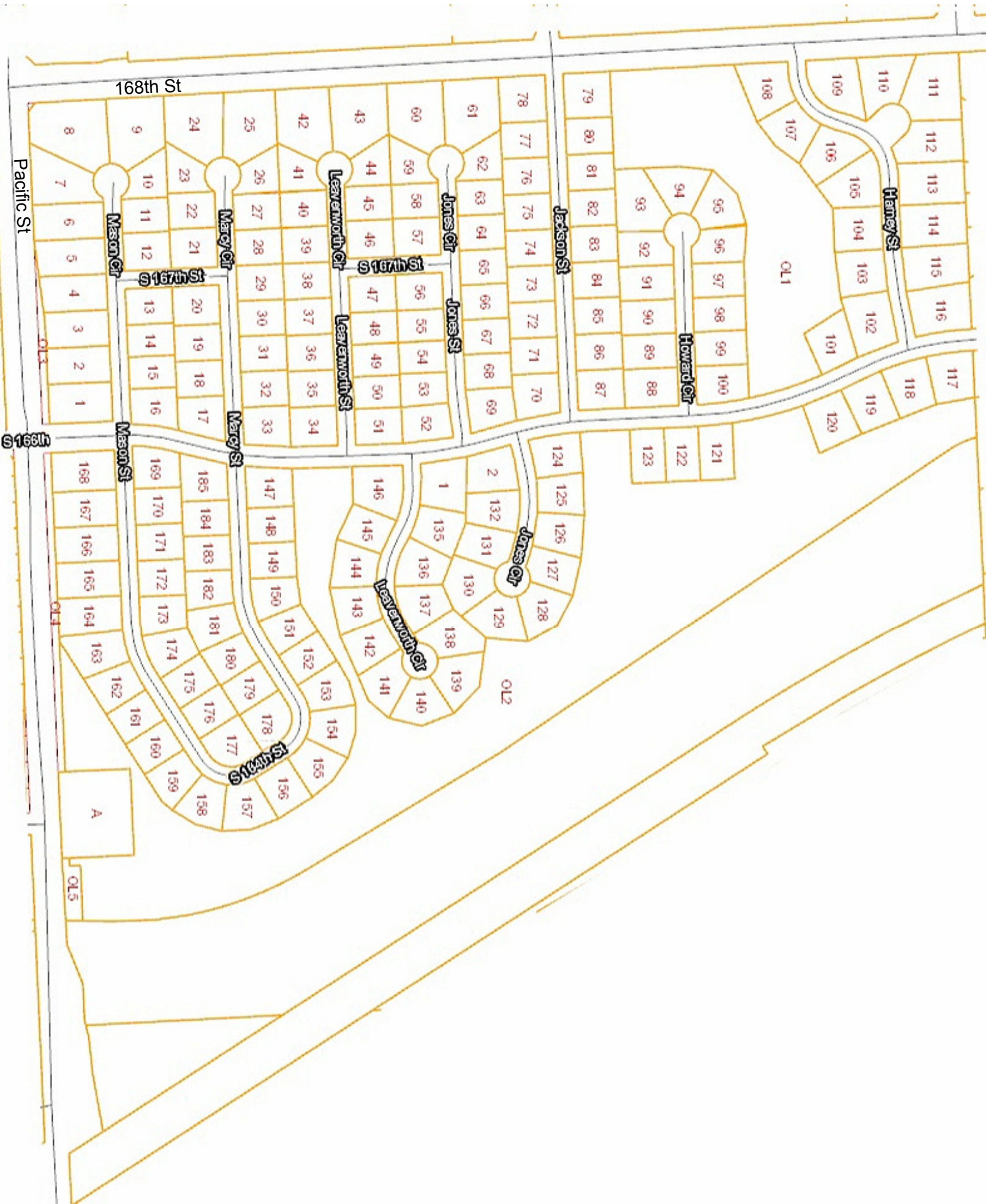

168th St

Pacific St

Mason Ct

Mason Ct

Mason St

Mason St

Mason St

Mason St

Mason St

Mason St

Mason St

Mason St

Mason St

Mason St

Mason St

Mason St

Mason St

8

9

24

23

22

21

20

19

18

17

16

15

14

13

12

11

10

11

12

13

14

15

16

17

18

19

20

21

22

23

24

25

26

27

28

29

9

10

23

22

21

20

19

18

17

16

15

14

13

12

11

10

11

12

13

14

15

16

17

18

19

20

21

22

23

24

25

26

27

28

29

30

10

11

22

21

20

19

18

17

16

15

14

13

12

11

10

11

12

13

14

15

16

17

18

19

20

21

22

23

24

25

26

27

28

29

30

31

11

12

21

20

19

18

17

16

15

14

13

12

11

10

11

12

13

14

15

16

17

18

19

20

21

22

23

24

25

26

27

28

29

30

31

32

12

13

22

21

20

19

18

17

16

15

14

13

12

11

10

11

12

13

14

15

16

17

18

19

20

21

22

23

24

25

26

27

28

29

30

31

13

14

23

22

21

20

19

18

17

16

15

14

13

12

11

10

11

12

13

14

15

16

17

18

19

20

21

22

23

24

25

26

27

28

29

30

14

15

24

23

22

21

20

19

18

17

16

15

14

13

12

11

10

11

12

13

14

15

16

17

18

19

20

21

22

23

24

25

26

27

28

29

15

16

25

24

23

22

21

20

19

18

17

16

15

14

13

12

11

10

11

12

13

14

15

16

17

18

19

20

21

22

23

24

25

26

27

28

16

17

26

25

24

23

22

21

20

19

18

17

16

15

14

13

12

11

10

11

12

13

14

15

16

17

18

19

20

21

22

23

24

25

26